

# Solid Fuel and Gas Component List

**2011**



**DAVIN INDUSTRIES**

Effective June 2011 – March 2012



## IMPORTANT NOTICE

This catalogue is issued subject to the following conditions.

- Goods ordered from this catalogue are subject to the standard terms and conditions of Davin Industries Limited.
- Please observe relevant installation and operating conditions pertaining to specific products when ordering.
- All technical specifications, including drawings, in this catalogue are provided for general information only. Please ensure your use and/or installation complies with the relevant Building Act and Local Body Regulations in your area. Davin Industries Limited assumes no responsibility for incorrect application or installation of any components based on the information provided in this catalogue.
- All details are subject to change without notice.

This catalogue is in effect from June 1<sup>st</sup> 2011. If you have any questions about the information contained in this document please call us on 03.384.3099.

## CONTACT DETAILS

**Inwards/Outwards Goods Address:**

● Newtown Street (Off Maces Road)  
Christchurch

**Office Address:**

● 11 Edison Place  
Bromley  
Christchurch

**Postal Address:**

PO Box 24015  
Christchurch

**Contact details:**

flues@davin.co.nz  
Phone: 03 384 3099  
Fax: 03 384 9666

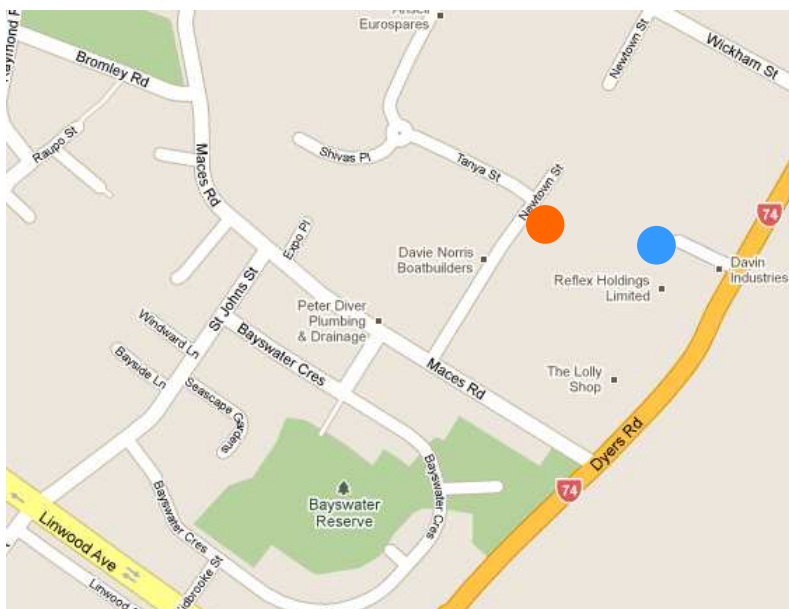

## TABLE OF CONTENTS

QUICK PARTS LIST .....	6
Kits .....	6
Stainless Steel Flues (1200mm lengths).....	6
Stainless Steel Flues (600mm lengths).....	6
Galvanised Steel Liners (1200mm lengths).....	6
Galvanised Steel Liners (600mm lengths).....	7
Cowls.....	7
Flashing Cones .....	7
Cowl, Cone and Top Spider Bracket Sets.....	8
Spider and Spacer Brackets.....	8
Mounting Rails.....	9
Stainless Steel Offsets .....	9
Galvanised Steel Offsets .....	9
Stainless Steel Fixed Bends – 45° .....	9
Galvanised Fixed Bends – 45° .....	9
Offset Bend Kits (comprising of two SS and two galv fixed bends).....	10
Offset Bend Kits (comprising of one SS and one galv telescopic bend).....	10
Extension Kits.....	10
Additional Components .....	10
Ceiling Plates.....	11
Shields.....	11
KITS .....	13
Ø150mm Insert Flue Kit – 4.2m .....	13
Revolving Cowl (shown) (2020).....	13
Fixed Cowl (2025) .....	13
Ø150mm Satin Black Stainless Steel Flue Kit 4.2m.....	14
Stainless Steel (2075)   Satin Black (2074).....	14
Ø150mm Stainless Steel Free Standing Flue Kit 3.6m .....	15
Stainless Steel (2022)   Satin Black (2023).....	15
Ø150mm Ceiling-Up Kit (2021) .....	15
Stainless Steel (2021).....	15
Ø175mm Free Standing Flue Kit 4.2m .....	15
Satin Black (2017).....	15
COMPONENTS .....	16
Galvanised Liners (1xx) .....	16
Stainless Steel Flues (2xx) .....	17
Combination Liners (1xx/8212) .....	18
Cowls (4xx/502) .....	19
Revolving Cowls      Fixed Cowls .....	19
Cowl, Cone & Top Spider Sets (5xx).....	19
“H” Top Cowl and Flashing Cone Set (5xx) .....	20
ADD Cowls, H-Top Cowls and Flashing Cones (individual items) (5xx/8xxx) .....	20
Top Spider Brackets (6xx) .....	21
Plain Spacer Brackets (6xx) .....	21
Bottom Spider Brackets (6xx) .....	21
Mounting Rails (7xx) .....	22

Telescopic Offsets (8xx/8xxx) .....	22
Combination Offsets (400mm centres) .....	22
Tee-Piece (808) .....	23
Adjustable Bend (820) .....	23
Fixed Bend – 45 Degree (8xx/8xxx).....	23
“Touch Up” Aerosol Cans (8xx).....	23
Starter Rings (816) .....	24
Floor Penetration Units (8xx).....	24
Chimney Flashing Plate (849) .....	24
Energy/Heat Saver Add-On Kit (8121) .....	25
Ceiling Plates (9xx) .....	26
Shields/Reflectors (1xx/1xxx) .....	27
 APPENDICES .....	 29
<i>Information Note for Building Inspectors Re: Davin Industries Flue Systems</i> .....	29
<i>Thermal Testing Report for #2023 Double Shielded Flue Kit</i> .....	29
<i>Safety Opinion Report for #2074 Flue Kit</i> .....	36

## QUICK PARTS LIST

## QUICK PARTS LIST

### Kits

2033	Free Standing Gas Flue Kit	Ø100
2034	Zero Clearance Gas Flue Kit	Ø100
2035	Chimney Liner Gas Flue Kit	Ø100
2020	Insert Flue Kit	Ø150 (Revolving Cowl)
2025	Insert Flue Kit	Ø150 (Fixed Cowl)
2021	Ceiling-Up Kit	Ø150
2022	Free Standing Flue Kit	Ø150 (3.6m, S/S)
2023	Free Standing Flue Kit	Ø150 (3.6m, Satin Black)
2075	Free Standing Flue Kit	Ø150 (4.2m, S/S)
2074	Free Standing Flue Kit	Ø150 (4.2m, Satin Black)
2017	Free Standing Flue Kit	Ø175 (4.2m, Satin Black)
2013	Free Standing Flue Kit	Ø200 (4.2m, Satin Black)

### Stainless Steel Flues (1200mm lengths)

200	Stainless Flue	Ø100
215	Stainless Flue	Ø115
246	Stainless Flue	Ø120
201	Stainless Flue	Ø125
202	Stainless Flue	Ø150
202SB	Stainless Flue Satin Black	Ø150
224	Stainless Flue	Ø175
224SB	Stainless Flue Satin Black	Ø175
206	Stainless Flue	Ø200
206SB	Stainless Flue Satin Black	Ø200
221	Stainless Flue	Ø225
207	Stainless Flue	Ø250
265	Stainless Flue	Ø275
208	Stainless Flue	Ø300
230	Stainless Flue	Ø350
261	Stainless Flue	Ø400
264	Stainless Flue	Ø450

### Stainless Steel Flues (600mm lengths)

229	Stainless Flue	Ø100
245	Stainless Flue	Ø115
252	Stainless Flue	Ø125
203	Stainless Flue	Ø150
236	Stainless Flue	Ø175
219	Stainless Flue	Ø200
228	Stainless Flue	Ø250
275	Stainless Flue	Ø275
257	Stainless Flue	Ø300

### Galvanised Steel Liners (1200mm lengths)

141	Galvanised Liner	Ø125
142	Galvanised Liner	Ø150
162	Galvanised Liner Unswaged	Ø150
117	Galvanised Liner	Ø175
101	Galvanised Liner	Ø200

138	Galvanised Liner	Ø225
113	Galvanised Liner	Ø245
103	Galvanised Liner	Ø250
156	Galvanised Liner Unswaged	Ø250
180	Galvanised Slip Liner Unswaged	Ø253
124	Galvanised Liner	Ø275
107	Galvanised Liner	Ø300
120	Galvanised Liner	Ø325
108	Galvanised Liner	Ø350
167	Galvanised Liner	Ø375
128	Galvanised Liner	Ø400
136	Galvanised Liner	Ø450
165	Galvanised Liner	Ø500
166	Galvanised Liner	Ø550
101W	Galvanised Liner with Brackets	Ø200
103W	Galvanised Liner with Swage	Ø250

## Galvanised Steel Liners (600mm lengths)

100	Galvanised Liner	Ø200
123	Galvanised Liner	Ø225
105	Galvanised Liner	Ø250
153	Galvanised Slip Liner Unswaged	Ø253
125	Galvanised Liner	Ø275
122	Galvanised Liner	Ø300
130	Galvanised Liner	Ø350
172	Galvanised Liner	Ø375
135	Galvanised Liner	Ø400

## Cowls

500	ADD Cowl	Ø115 Stainless Steel (requires flashing cone)
540	ADD Cowl	Ø125 Stainless Steel (requires flashing cone)
511	ADD Cowl	Ø150 Stainless Steel (requires flashing cone)
508	ADD Cowl	Ø175 Stainless Steel (requires flashing cone)
506	ADD Cowl	Ø200 Stainless Steel (requires flashing cone)
515	ADD Cowl	Ø225 Stainless Steel (requires flashing cone)
513	ADD Cowl	Ø250 Stainless Steel (requires flashing cone)
510	ADD Cowl	Ø300 Stainless Steel (requires flashing cone)
542	ADD Cowl	Ø350 Stainless Steel (requires flashing cone)
554	ADD Cowl	Ø400 Stainless Steel (requires flashing cone)
502	Fixed Cowl	Ø150 Stainless Steel
525	Gas Cowl	Ø100 Stainless Steel
578	Gas Cowl	Ø200 Stainless Steel
581	Gas Cowl	Ø250 Stainless Steel
582	Gas Cowl	Ø300 Stainless Steel
583	H-Top Cowl	Ø150 Stainless Steel (requires flashing cone)
543	H-Top Cowl	Ø200 Stainless Steel (requires flashing cone)
401	Revolving Cowl	Ø150 Stainless Steel
402	Revolving Cowl	Ø280 Stainless Steel - (Clamp Type)
579	Rocket Cowl	Ø125 Stainless Steel - (requires flashing cone)
567	Rocket Cowl	Ø150 Stainless Steel - (requires flashing cone)

## Flashing Cones

810	Flashing Cone	Ø115/250 Stainless Steel
8009	Flashing Cone	Ø125/250 Stainless Steel

8054	Flashing Cone	Ø150/200 Stainless Steel
802	Flashing Cone	Ø150/250 Stainless Steel
861	Flashing Cone	Ø150/300 Stainless Steel
829	Flashing Cone	Ø175/275 Stainless Steel
8003	Flashing Cone	Ø175/300 Stainless Steel
8032	Flashing Cone	Ø200/250 Stainless Steel
865	Flashing Cone	Ø200/300 Stainless Steel
8020	Flashing Cone	Ø225/325 Stainless Steel
8048	Flashing Cone	Ø250/300 Stainless Steel
854	Flashing Cone	Ø250/350 Stainless Steel
8049	Flashing Cone	Ø300/350 Stainless Steel
833	Flashing Cone	Ø300/400 Stainless Steel
8095	Flashing Cone	Ø350/400 Stainless Steel
8010	Flashing Cone	Ø350/450 Stainless Steel
8074	Flashing Cone	Ø400/500 Stainless Steel

## Cowl, Cone and Top Spider Bracket Sets

541	ADD Cowl & Cone Set	Ø125/250mm
576	ADD Cowl & Cone Set	Ø150/200mm
516	ADD Cowl & Cone Set	Ø150/250mm
577	ADD Cowl & Cone Set	Ø175/275mm
545	ADD Cowl & Cone Set	Ø200/250mm
552	ADD Cowl & Cone Set	Ø200/300mm
548	ADD Cowl & Cone Set	Ø225/325mm
546	ADD Cowl & Cone Set	Ø250/300mm
549	ADD Cowl & Cone Set	Ø250/350mm
547	ADD Cowl & Cone Set	Ø300/350mm
550	ADD Cowl & Cone Set	Ø300/400mm
565	ADD Cowl & Cone Set	Ø350/400mm
571	ADD Cowl & Cone Set	Ø350/450mm
560	ADD Cowl & Cone Set	Ø400/500mm
518	H-Top Cowl & Cone Set	Ø150/250mm
519	H-Top Cowl & Cone Set	Ø150/300mm
566	Rocket Cowl & Cone Set	Ø125/225mm
580	Rocket Cowl & Cone Set	Ø150/250mm

## Spider and Spacer Brackets

628	Top Spider Bracket	Ø100/150 Stainless Steel
651	Top Spider Bracket	Ø115/200/250 Stainless Steel
696	Top Spider Bracket	Ø125/175/225 Stainless Steel
6100	Top Spider Bracket	Ø150/200 Stainless Steel
622	Top Spider Bracket	Ø150/200/250 Stainless Steel
643	Top Spider Bracket	Ø175/225/275 Stainless Steel
664	Top Spider Bracket	Ø200/250 Stainless Steel
623	Top Spider Bracket	Ø200/250/300 Stainless Steel
662	Top Spider Bracket	Ø225/325 Stainless Steel
671	Top Spider Bracket	Ø250/300 Stainless Steel
665	Top Spider Bracket	Ø250/350 Stainless Steel
672	Top Spider Bracket	Ø300/350 Stainless Steel
654	Top Spider Bracket	Ø300/400 Stainless Steel
688	Top Spider Bracket	Ø350/400 Stainless Steel
697	Top Spider Bracket	Ø350/450 Stainless Steel
675	Top Spider Bracket	Ø400/500 Stainless Steel
631	Plain Spacer Bracket	Ø100/150 Stainless Steel
634	Plain Spacer Bracket	Ø100/170 Stainless Steel

6110	Plain Spacer Bracket	Ø125/225 Stainless Steel
626	Plain Spacer Bracket	Ø150/200 Stainless Steel
699	Plain Spacer Bracket	Ø175/225 Stainless Steel
621	Plain Spacer Bracket	Ø200/250 Stainless Steel
6111	Plain Spacer Bracket	Ø200/300 Stainless Steel
679	Plain Spacer Bracket	Ø225/275 Stainless Steel
659	Plain Spacer Bracket	Ø225/325 Stainless Steel
613	Plain Spacer Bracket	Ø250/300 Stainless Steel
608	Plain Spacer Bracket	Ø250/350 Stainless Steel
669	Plain Spacer Bracket	Ø300/350 Stainless Steel
653	Plain Spacer Bracket	Ø300/400 Stainless Steel
682	Plain Spacer Bracket	Ø400/450 Stainless Steel
670	Plain Spacer Bracket	Ø400/500 Stainless Steel
657	Standard Spider Bracket	Ø125/200/250 Stainless Steel
602	Bottom Spider Bracket	Ø150/200/250 Stainless Steel
604	Standard Spider Bracket	Ø200/250/300 Stainless Steel
634	Bottom Spider Bracket	Ø100/150 Stainless Steel
644	Bottom Spider Bracket	Ø175/225/275 Stainless Steel
650	Bottom Spider Bracket	Ø250/350 Stainless Steel

## Mounting Rails

701	Mounting Rail	600 x 40 x 40 Galvanised
702	Mounting Rail	950 x 40 x 40 Galvanised
703	Mounting Rail	1200 x 40 x 40 Galvanised

## Stainless Steel Offsets

806	Telescopic Offset Bend	Ø125 Stainless Steel
801	Telescopic Offset Bend	Ø150 Stainless Steel
8022	Telescopic Offset Bend	Ø200 Stainless Steel
8055	Telescopic Offset Bend	Ø250 Stainless Steel
8068	Telescopic Offset Bend	Ø300 Stainless Steel

## Galvanised Steel Offsets

8114	Telescopic Offset Bend	Ø200 Galvanised Steel
8063	Telescopic Offset Bend	Ø250 Galvanised Steel
8067	Telescopic Offset Bend	Ø300 Galvanised Steel
8065	Telescopic Offset Bend	Ø325mm Galvanised Steel
8069	Telescopic Offset Bend	Ø350mm Galvanised Steel
8073	Telescopic Offset Bend	Ø400mm Galvanised Steel

## Stainless Steel Fixed Bends – 45°

882	Fixed Bend	Ø100mm
8036	Fixed Bend	Ø150mm
851	Fixed Bend	Ø200mm
8041	Fixed Bend	Ø250mm
8086	Fixed Bend	Ø300mm
8122	Fixed Bend	Ø350mm

## Galvanised Fixed Bends – 45°

8028	Fixed Bend	Ø150mm
8094	Fixed Bend	Ø200mm
8052	Fixed Bend	Ø250mm

8085	Fixed Bend	Ø300mm
8042	Fixed Bend	Ø350mm
8091	Fixed Bend	Ø400mm

### Offset Bend Kits (comprising of two SS and two galv fixed bends)

8134	Fixed Bend Pairs	Ø150/200mm
8097	Fixed Bend Pairs	Ø200/250mm
8130	Fixed Bend Pairs	Ø250/300mm
8140	Fixed Bend Pairs	Ø250/350mm
8143	Fixed Bend Pairs	Ø300/350mm
8181	Fixed Bend Pairs	Ø300/400mm

### Offset Bend Kits (comprising of one SS and one galv telescopic bend)

8058	Telescopic Bend Kit	Ø200/250mm
8071	Telescopic Bend Kit	Ø250/300mm
8070	Telescopic Bend Kit	Ø300/350mm

### Extension Kits

8141	Flue, Liner & Spacer Bracket	Ø100/150mm
8127	Flue, Liner & Spacer Bracket	Ø150/200mm
8096	Flue, Liner & Spacer Bracket	Ø150/200/250mm
8096MB	Flue, Liner & Spacer Bracket (black)	Ø150/200/250mm
8045	Flue, Liner & Spacer Bracket	Ø200/250mm
8059	Flue, Liner & Spacer Bracket	Ø200/300mm
8046	Flue, Liner & Spacer Bracket	Ø250/300mm
8037	Flue, Liner & Spacer Bracket	Ø250/350mm
8044	Flue, Liner & Spacer Bracket	Ø300/350mm
8047	Flue, Liner & Spacer Bracket	Ø300/400mm
8062	Flue, Liner & Spacer Bracket	Ø350/400mm
8100	Flue, Liner & Spacer Bracket	Ø400/450mm
8050	Flue, Liner & Spacer Bracket	Ø400/500mm

### Additional Components

891	Aluminium Flexi Flue	Ø100mm, 3.6 metres
884	Flexi Flue Joiner	Ø100mm
893	Flexi Flue Lower Joiner/Adapter	Ø100mm
8012	Flexi Flue Upper Adapter	Ø100mm x 400
808	Tee-Piece	Ø150mm, 90° (with Cap)
820	Adjustable Bend	Ø150 Stainless Steel
841	Stove Bright Aerosol Can	Satin Black
890	Stove Bright Aerosol Can	Metallic Black
816	Starter Ring	Ø150 Stainless Steel
817	Floor Penetration Unit	Ø200/250 (with Stainless Steel Floor Plate)
871	Floor Penetration Unit	Ø225/275 (with Stainless Steel Floor Plate)
825	Floor Plate	Ø200/250 Stainless Steel
887	Chimney Flashing Plate	Ø100, (300 x 400 Overall sizes), Galvanised
849	Chimney Flashing Plate	Ø250, (300 x 400 Overall sizes), Galvanised
8121	Energy/Heat Saver Add-On	Ø150

## Ceiling Plates

930MB	Ceiling Plate	250 x 250 (Ø100 Flue) Metallic Black
932MB	Ceiling Plate	340 x 340 (Ø100 Flue) Metallic Black
900	Ceiling Plate	380 x 380 (Ø150 Flue) Powdercoated Matt Black
901	Ceiling Plate	380 x 380 (Ø150 Flue) Powdercoated White
902	Ceiling Plate	380 x 380 (Ø150 Flue) Powdercoated White (2 Piece)
902MB	Ceiling Plate	380 x 380 (Ø150 Flue) Powdercoated Matt Black (2 Piece)
903	Ceiling Plate	430 x 430 (Multi Dia) Powdercoated White
903MB	Ceiling Plate	430 x 430 (Multi Dia) Powdercoated Matt Black
911	Ceiling Plate	500 x 430 (Multi Dia) Powdercoated White, 30° Angle
904	Ceiling Plate	500 x 430 (Multi Dia) Powdercoated White, 45° Angle
904MB	Ceiling Plate	500 x 430 (Multi Dia) Powdercoated Black, 45° Angle
905	Ceiling Plate	580 x 580 (Ø150 Flue) Powdercoated White
915	Ceiling Plate	410 x 410 (Ø175 Flue) Powdercoated White
955	Ceiling Plate	430 x 430 (Ø150 Flue) Powdercoated White

## Shields

112	Half Shield	Ø250 x 1000 Matt Black
182	Shield Extension	Ø250 x 300 Matt Black
1006	Single Stainless Reflector	Ø150 x 1200 Stainless Steel
1001	Reflector	Ø150 x 1200 Matt Black
1002	Deluxe Flue Shield	Ø150 x 1200 Matt Black
1004	Back Extension	920 Long, Matt Black
1013	Single Stainless Reflector	Ø175 x 1200 Stainless Steel
1019	Reflector	Ø175 x 1200 Matt Black

## KITS AND COMPONENTS

## KITS

### Ø150mm Insert Flue Kit – 4.2m

#### Revolving Cowl (shown) (2020)

Code	Qty	Description
202	3	Ø150mm x 1200mm Stainless Steel Flue
203	1	Ø150mm x 600mm Stainless Steel Flue
602	2	Ø150mm Spider Bracket
402	1	Ø280mm Revolving Cowl
	1	Flue Fastener kit

#### Fixed Cowl (2025)

Code	Qty	Description
202	3	Ø150mm x 1200mm Stainless Steel Flue
203	1	Ø150mm x 600mm Stainless Steel Flue
602	2	Ø150mm Spider Bracket
502	1	Ø150mm Fixed Cowl
	1	Flue Fastener kit

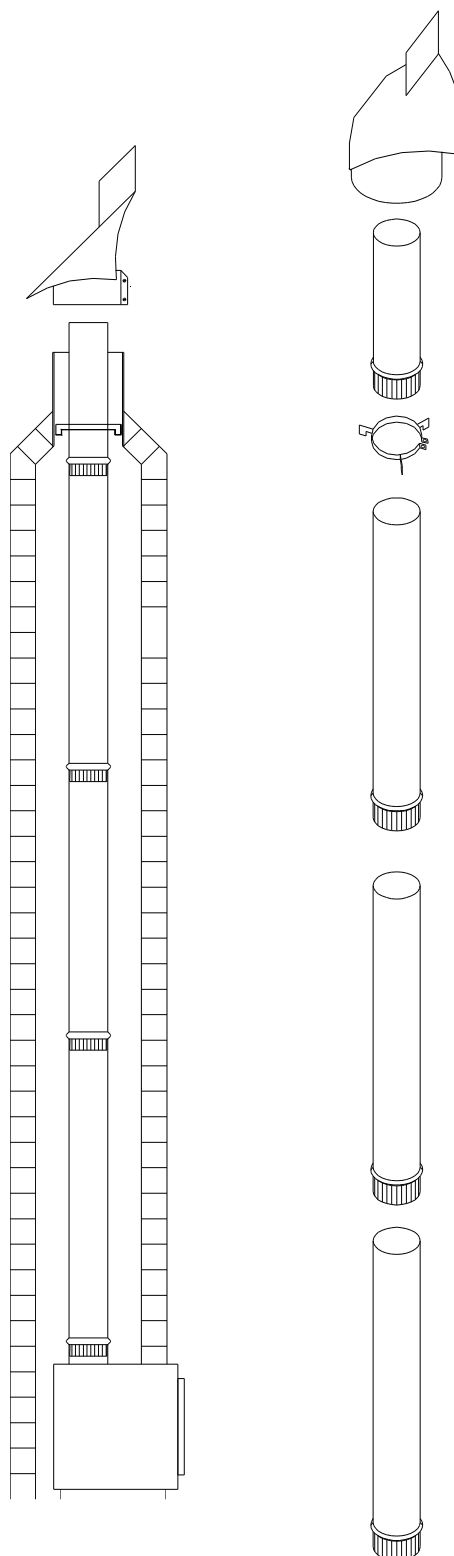

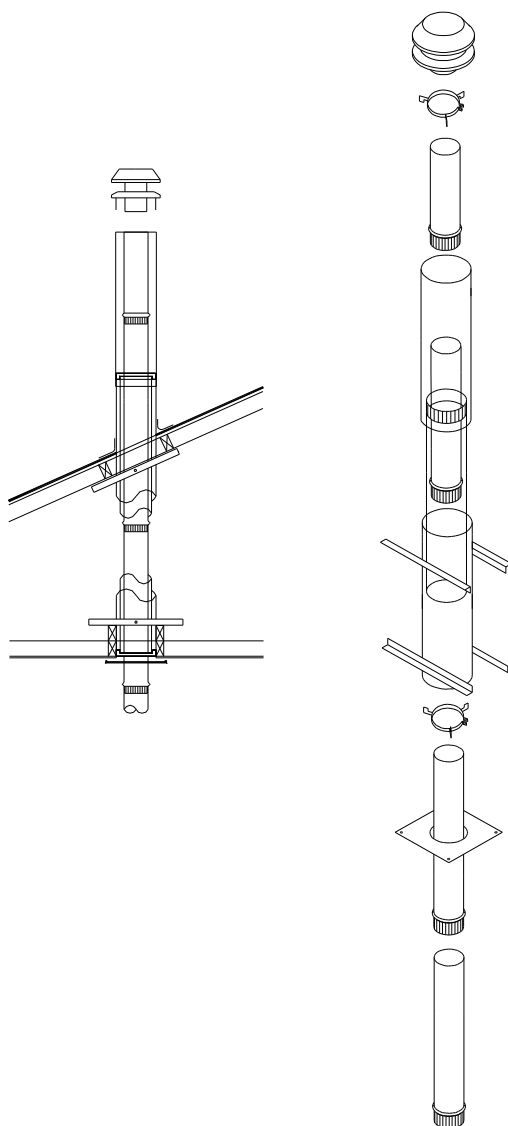
**Ø150mm Satin Black Stainless Steel Flue Kit 4.2m****Stainless Steel (2075) Satin Black (2074)**

Code	Qty	Description
202	3	Ø150mm x 1200mm Stainless Steel Flue
203	1	Ø150mm x 600mm Stainless Steel Flue
101	1	Ø200mm x 1200mm Galvanised Liner
156	1	Ø250mm x 1200mm Unswaged Galv Liner
180	1	Ø253mm x 1200mm Unswaged Galv Slip Liner
602	2	Ø150mm Spider Bracket
901	1	380mm x 380mm White Ceiling Plate
502	1	Ø150mm Fixed Cowl
	1	Flue Fastener kit

## Ø150mm Stainless Steel Free Standing Flue Kit 3.6m

**Stainless Steel (2022) Satin Black (2023)**

Code	Qty	Description
202	3	Ø150mm x 1200mm Stainless Steel Flue
101	1	Ø200mm x 1200mm Galvanised Liner
156	1	Ø250mm x 1200mm Unswaged Galv Liner
153	1	Ø253mm x 600mm Unswaged Galv Slip Liner
602	2	Ø150mm Spider Bracket
901	1	380mm x 380mm White Ceiling Plate
502	1	Ø150mm Fixed Cowl
	1	Flue Fastener kit

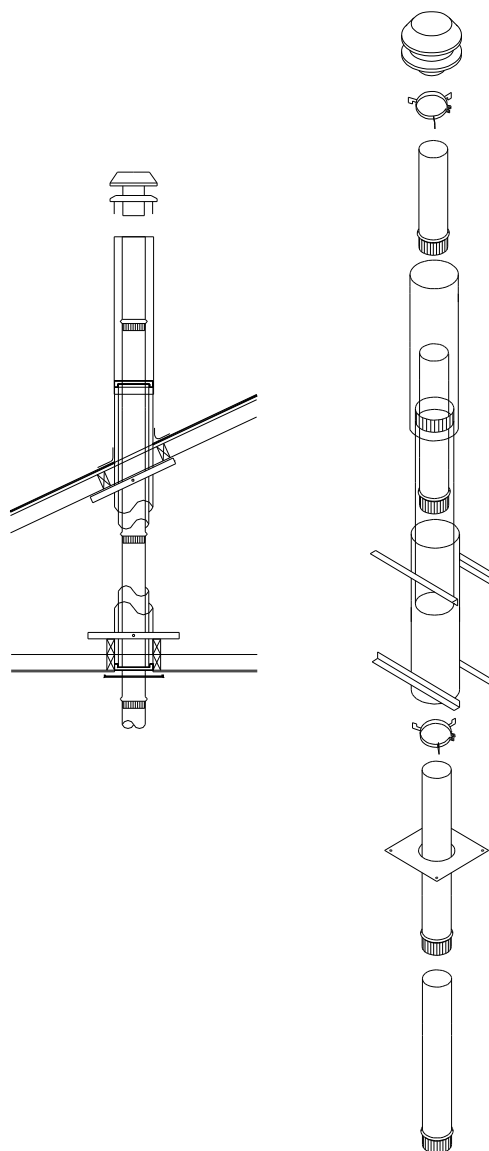

## Ø150mm Ceiling-Up Kit (2021)

**Stainless Steel (2021)**

Code	Qty	Description
202	1	Ø150mm x 1200mm Stainless Steel Flue
203	1	Ø150mm x 600mm Stainless Steel Flue
101	1	Ø200mm x 1200mm Galvanised Liner
156	1	Ø250mm x 1200mm Unswaged Galvanised Liner
180	1	Ø253mm x 1200mm Galvanised Slip Liner
602	2	Ø150mm Spider Bracket
901	1	380mm x 380mm White Ceiling Plate
502	1	Ø150mm Fixed Cowl
	1	Flue Fastener kit

## Ø175mm Free Standing Flue Kit 4.2m

**Satin Black (2017)**

Code	Qty	Description
224	3	Ø175mm x 1200mm Stainless Steel Flue
236	1	Ø175mm x 600mm Stainless Steel Flue
138	1	Ø225mm x 1200mm Galvanised Liner
124	2	Ø275mm x 1200mm Unswaged Galv Liner
644	2	Ø175mm Spider Bracket
915	1	410mm x 410mm White Ceiling Plate
577	1	Ø175mm ADD Cowl with Cone and Spider
	1	Flue Fastener kit

## COMPONENTS

### Galvanised Liners (1xx)

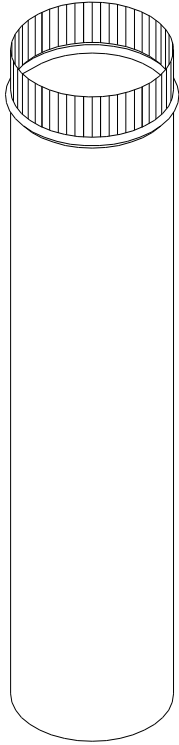

Galvanised Liner

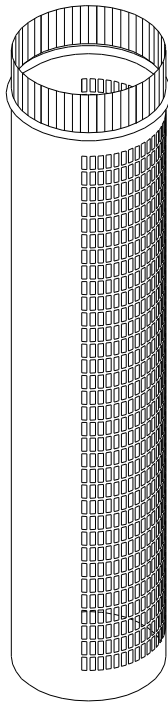

Half Shield

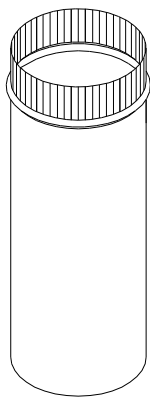

Shield Extension

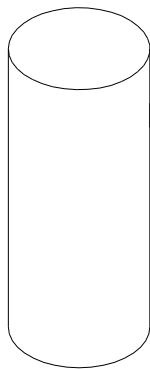

Slip Liner

Code	Size
141	Ø125mm x 1200mm
142	Ø150mm x 1200mm
117	Ø175mm x 1200mm
101	Ø200mm x 1200mm
138	Ø225mm x 1200mm
113	Ø245mm x 1200mm
103	Ø250mm x 1200mm
103MB	Ø250mm x 1200mm (black)
156	Ø250mm x 1200mm Unswaged
112	Ø250mm x 1000mm Half Shield Matt Black
180	Ø253mm x 1200mm Unswaged Slip Liner
124	Ø275mm x 1200mm
107	Ø300mm x 1200mm
120	Ø325mm x 1200mm
108	Ø350mm x 1200mm
167	Ø375mm x 1200mm
128	Ø400mm x 1200mm
136	Ø450mm x 1200mm
165	Ø500mm x 1200mm
166	Ø550mm x 1200mm

Code	Size
100	Ø200mm x 600mm
123	Ø225mm x 600mm
182	Ø250mm x 300mm Shield Ext. Matt Black
105	Ø250mm x 600mm
153	Ø253mm x 600mm Slip Liner
125	Ø275mm x 600mm
122	Ø300mm x 600mm
130	Ø350mm x 600mm
172	Ø375mm x 600mm
135	Ø400mm x 600mm

## Stainless Steel Flues (2xx)

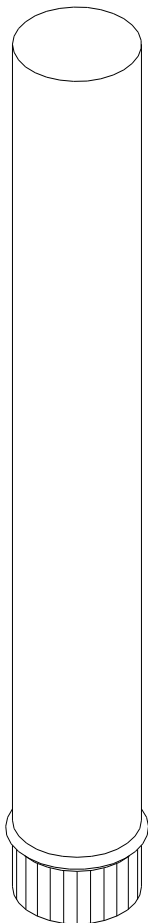

Code	Size
200	Ø100mm × 1200mm
215	Ø115mm × 1200mm
246	Ø120mm × 1200mm
201	Ø125mm × 1200mm
202	Ø150mm × 1200mm
202SB	Ø150mm × 1200mm Satin Black *
224	Ø175mm × 1200mm
224SB	Ø175mm × 1200mm Satin Black *
206	Ø200mm × 1200mm
206SB	Ø200mm × 1200mm Satin Black *
221	Ø225mm × 1200mm
207	Ø250mm × 1200mm
265	Ø275mm × 1200mm
208	Ø300mm × 1200mm
230	Ø350mm × 1200mm
261	Ø400mm × 1200mm
264	Ø450mm × 1200mm
229	Ø100mm × 600mm
245	Ø115mm × 600mm
252	Ø125mm × 600mm
203	Ø150mm × 600mm
236	Ø175mm × 600mm
219	Ø200mm × 600mm
228	Ø250mm × 600mm
275	Ø275mm × 600mm
257	Ø300mm × 600mm

\*Details on the use of stainless steel satin black hi-temp flues

1. Stainless Steel Satin Black Hi-Temp Flues must be swept by mechanical means only. (We recommend mixed head or polypropylene brushes). Under NO circumstances should chemical flue cleaners, (soot destroyers) or steel chimney brushes be used.
2. Stainless Steel Satin Black Hi-Temp Flues should not be used on a heater burning treated or wet (unseasoned) wood.
3. Stainless Steel Satin Black Hi-Temp Flue sections should be secured with stainless steel rivets or self-tapping screws.
4. The paint finish appearance may change, depending on heater operation and is designed to be a maintainable finish. To maintain paint finish or touch up use only genuine Stove-Bright Aerosol.
5. Stainless Steel Satin Black Hi-Temp Flues must be installed in accordance with the heater manufacturer installation instructions. It is the responsibility of the installer to ensure no water leaks into the Hi-Temp Flue.

## Combination Liners (1xx/8212)

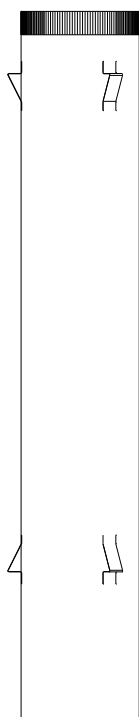

101 with  
brackets

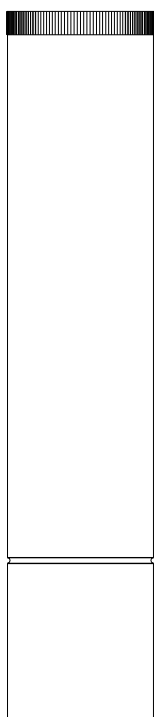

103 with swage



101 with brackets +  
103 with swage  
assembly

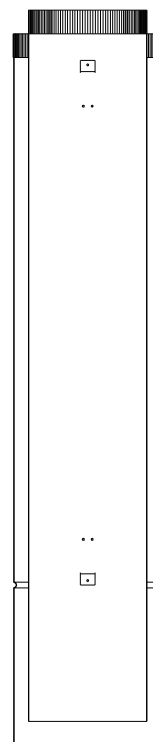

Assembly cross  
section view

Code	Size
101with brackets	Ø200mm x 1200mm Galvanised Liner with Brackets
103 with swage	Ø250mm x 1200mm Galvanised Liner with Swage

## Cowls (4xx/502)

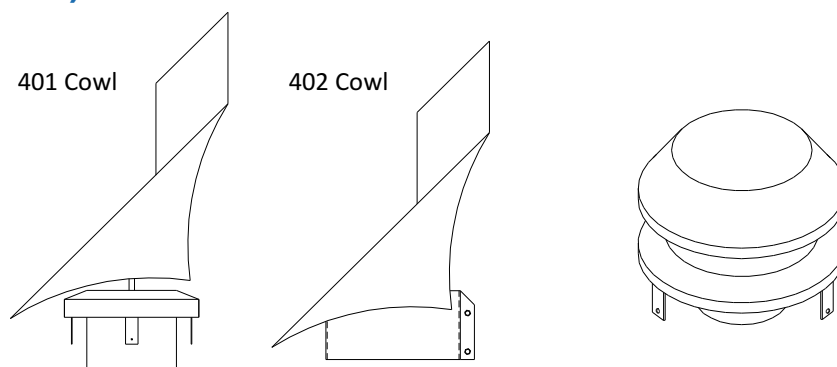

### Revolving Cowls

Code	Size
401	Ø150mm Stainless Steel
402	Ø280mm Stainless Steel Clamp Type

### Fixed Cowls

Code	Size
502	Ø150mm Stainless Steel

## Cowl, Cone & Top Spider Sets (5xx)

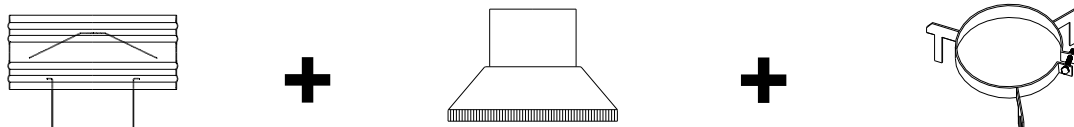

Code	Size
541	Ø125/250mm ADD Cowl, Cone & Top Spider Bracket
576	Ø150/200mm ADD Cowl, Cone & Top Spider Bracket
516	Ø150/250mm ADD Cowl, Cone & Top Spider Bracket
577	Ø175/275mm ADD Cowl, Cone & Top Spider Bracket
545	Ø200/250mm ADD Cowl, Cone & Top Spider Bracket
552	Ø200/300mm ADD Cowl, Cone & Top Spider Bracket
548	Ø225/325mm ADD Cowl, Cone & Top Spider Bracket
546	Ø250/300mm ADD Cowl, Cone & Top Spider Bracket
549	Ø250/350mm ADD Cowl, Cone & Top Spider Bracket
547	Ø300/350mm ADD Cowl, Cone & Top Spider Bracket
550	Ø300/400mm ADD Cowl, Cone & Top Spider Bracket
565	Ø350/400mm ADD Cowl, Cone & Top Spider Bracket
571	Ø350/450mm ADD Cowl, Cone & Top Spider Bracket
560	Ø400/500mm ADD Cowl, Cone & Top Spider Bracket
566	Ø125/225mm Rocket Cowl, Cone & Top Spider Bracket
580	Ø150/250mm Rocket Cowl, Cone & Top Spider Bracket

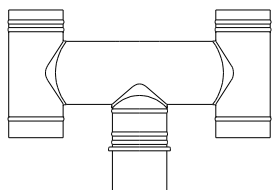
**“H” Top Cowl and Flashing Cone Set (5xx)**

“H” Top Cowl

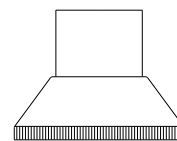

Flashing Cone

Code	Size
518	Ø150mm “H” Top Cowl & Ø150 – 250mm Flashing Cone
519	Ø150mm “H” Top Cowl & Ø150 – 300mm Flashing Cone

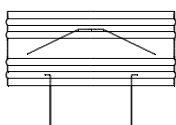
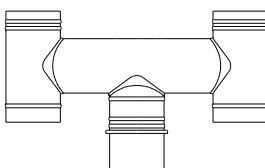
**ADD Cowls, H-Top Cowls and Flashing Cones (individual items)  
(5xx/8xxx)**Anti Down Draught  
Cowl (ADD)

“H” Top Cowl

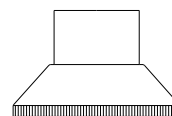

Flashing Cone

Code	Size
525	Ø100mm Bvent ADD Cowl including cone
500	Ø115mm ADD Cowl only
540	Ø125mm ADD Cowl only
511	Ø150mm ADD Cowl only
508	Ø175mm ADD Cowl only
506	Ø200mm ADD Cowl only
515	Ø225mm ADD Cowl only
513	Ø250mm ADD Cowl only
510	Ø300mm ADD Cowl only
542	Ø350mm ADD Cowl only
554	Ø400mm ADD Cowl only
583	Ø150mm “H-Top” Cowl only
543	Ø200mm “H-Top” Cowl only

Code	Size
810	Ø115 – 250mm
8009	Ø125 – 250mm
8054	Ø150 – 200mm
802	Ø150 – 250mm
861	Ø150 – 300mm
829	Ø175 – 275mm
8003	Ø175 – 300mm
8032	Ø200 – 250mm
865	Ø200 – 300mm
8020	Ø225 – 325mm
8048	Ø250 – 300mm
854	Ø250 – 350mm
8049	Ø300 – 350mm
833	Ø300 – 400mm
8095	Ø350 – 400mm
8010	Ø350 – 450mm
8074	Ø400 – 500mm

## Top Spider Brackets (6xx)

Code	Size
628	Ø100/150mm
651	Ø115/200/250mm
696	Ø125/175/225mm
646	Ø125/200/250mm
6100	Ø150/200mm
622	Ø150/200/250mm
643	Ø175/225/275mm
664	Ø200/250mm
623	Ø200/250/300mm
662	Ø225/325mm
671	Ø250/300mm
665	Ø250/350mm
672	Ø300/350mm
654	Ø300/400mm
688	Ø350/400mm
697	Ø350/450mm
675	Ø400/500mm

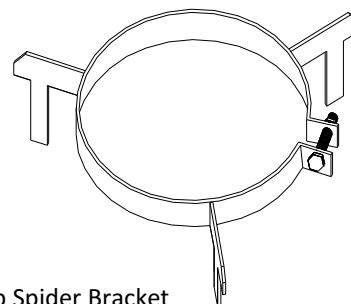

Top Spider Bracket

## Plain Spacer Brackets (6xx)

Code	Size
631	Ø100/150mm
626	Ø150/200mm
699	Ø175/225mm
621	Ø200/250mm
6111	Ø200/300mm
679	Ø225/275mm
659	Ø225/325mm
613	Ø250/300mm
608	Ø250/350mm
669	Ø300/350mm
653	Ø300/400mm
682	Ø400/450mm
670	Ø400/500mm

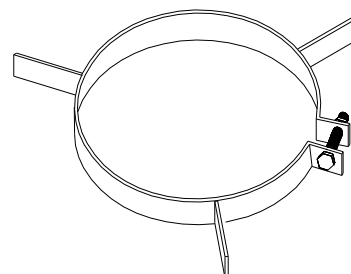

Plain Spacer Bracket

## Bottom Spider Brackets (6xx)

Code	Size
657	Ø125/200/250mm Stainless Steel
602	Ø150/200/250mm Stainless Steel
644	Ø175/225/275mm Stainless Steel
604	Ø200/250/300mm Stainless Steel
650	Ø200/350mm Stainless Steel

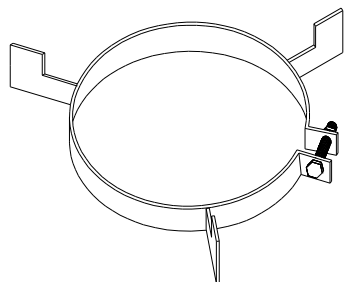

Bottom Spacer Bracket

## Mounting Rails (7xx)

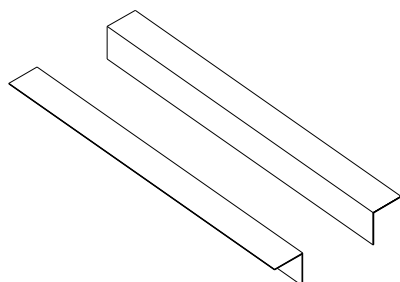

Code	Size
701	600mm x 40 x 40 Galvanised
702	950mm x 40 x 40 Galvanised
703	1200mm x 40 x 40 Galvanised

## Telescopic Offsets (8xx/8xxx)

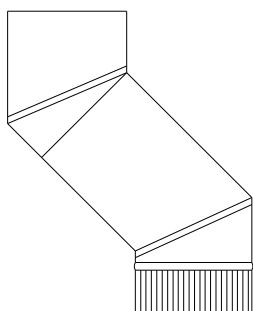

Code	Size
806	Ø125mm Stainless Steel
801	Ø150mm Stainless Steel
8022	Ø200mm Stainless Steel
8055	Ø250mm Stainless Steel
8068	Ø300mm Stainless Steel

Code	Size
8114	Ø200mm Galvanised Steel
8063	Ø250mm Galvanised Steel
8067	Ø300mm Galvanised Steel
8065	Ø325mm Galvanised Steel
8069	Ø350mm Galvanised Steel
8073	Ø400mm Galvanised Steel

## Combination Offsets (400mm centres)

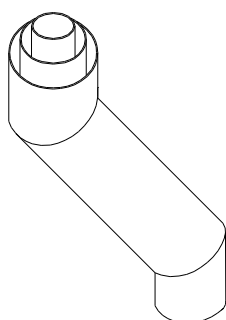

Code	Size
814	Ø150/200/250mm
Custom combo	Ø150/200/250mm (up to 850)

## Tee-Piece (808)

Code	Size
808	90° Ø150mm with cap

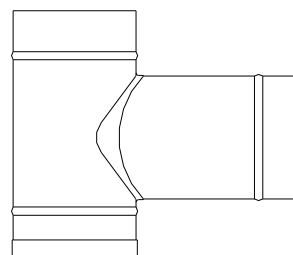

## Adjustable Bend (820)

Code	Size
820	Ø150mm Stainless Steel

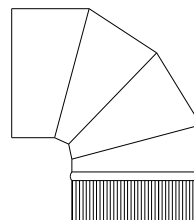

## Fixed Bend – 45 Degree (8xx/8xxx)

Code	Size
8036	Ø150mm Stainless Steel
851	Ø200mm Stainless Steel
8041	Ø250mm Stainless Steel
8086	Ø300mm Stainless Steel
8122	Ø350mm Stainless Steel

Code	Size
8028	Ø150mm Galvanised Steel
8094	Ø200mm Galvanised Steel
8052	Ø250mm Galvanised Steel
8085	Ø300mm Galvanised Steel
8042	Ø350mm Galvanised Steel
8091	Ø400mm Galvanised Steel

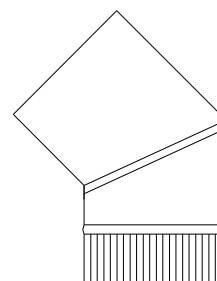

## “Touch Up” Aerosol Cans (8xx)

Code	Size
841	Stove Bright Satin Black
890	Stove Bright Metallic Black

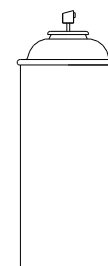

## Starter Rings (816)

Code	Size
816	Ø150mm Stainless Steel

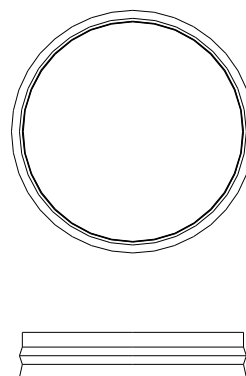

## Floor Penetration Units (8xx)

Code	Size
817	Ø200/250mm with Stainless Steel Floor Plate (not shown)
871	Ø225/275mm with Stainless Steel Floor Plate (not shown)
825	Ø200/250mm Stainless Steel Floor Plate to suit 817

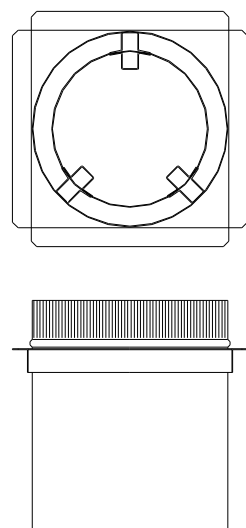

## Chimney Flashing Plate (849)

Code	Size
849	Ø250mm Galvanised

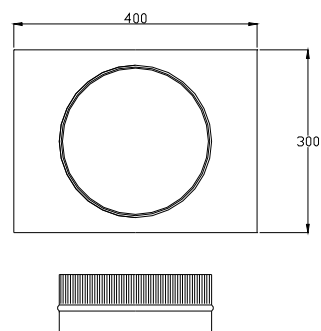

## Energy/Heat Saver Add-On Kit (8121)

Code	Size
8121	Ø150mm

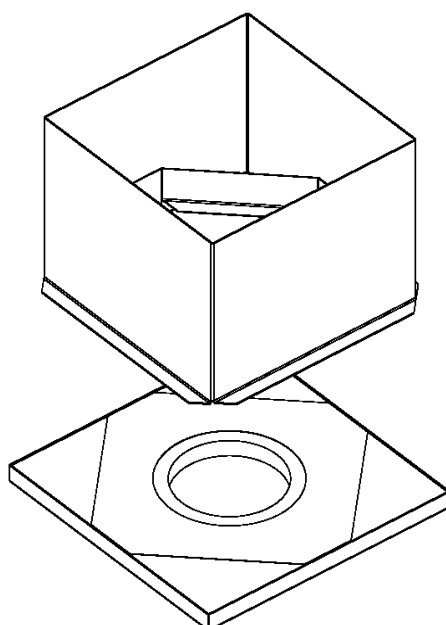

### Details on Ø150mm Energy/Heat Saver Add-On Kit

The Energy/Heat Saver add-on uses a thermo-syphon principle where air from either the ceiling cavity or outside is drawn into the Outer Casing and cools the flue system.

The Energy/Heat Saver add-on minimises room air from being drawn up the Outer Casing and being wasted.

The Energy/Heat Saver add-on Kit is a basic conversion kit. It is a practical solution, simply add the Energy/Heat Saver Add-On Kit to any Ø150mm Free Standing Flue Kit.

Note: The Energy/Heat Saver Add-On can only be used on Ø150mm Free Standing Flue Kits, Ceiling Kits or with components.

## Ceiling Plates (9xx)

900	380mm sq, Ø150mm, Matt Black
901	380mm sq, Ø150mm, White
955	430mm sq, Ø150mm, White
915	410mm sq, Ø175mm, White

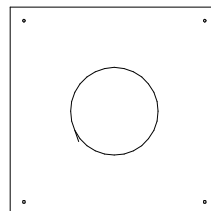

902	380mm sq, Ø150mm, White, 2 piece
902MB	380mm sq, Ø150mm, Matt Black, 2 piece

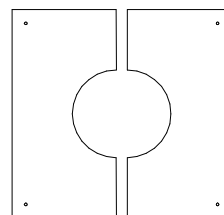

903	430mm sq, Multi Dia, White
903MB	430mm sq, Multi Dia, Matt Black

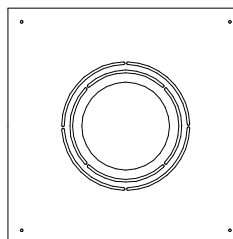

911	500mm x 430mm, Multi Dia, White, 30°
904	500mm x 430mm, Multi Dia, White, 45°

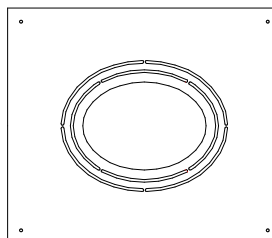

905	580mm sq, Ø150mm, White
-----	-------------------------

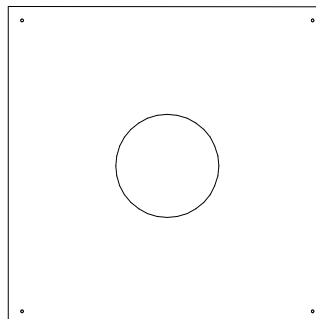

## Shields/Reflectors (1xx/1xxx)

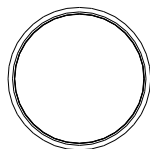

Half Shield – 112

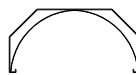
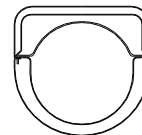
Reflector - 1006  
Reflector - 1013

Reflector - 1001  
Reflector - 1019

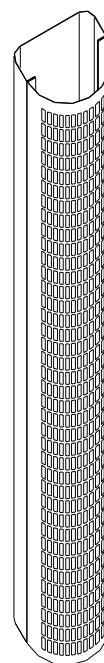
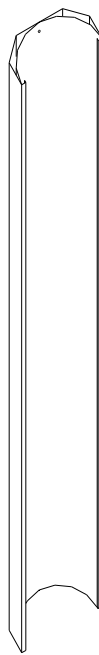
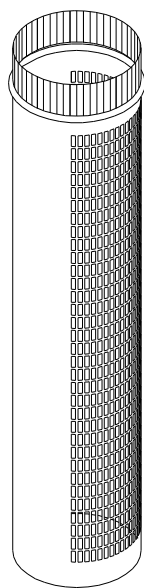

Deluxe Flue Shield - 1002



Code	Size
112	Ø250mm x 1000mm Half Shield (Matt Black)
182	Ø250mm x 300mm Shield Extension (Matt Black)
1006	Ø150mm x 1200mm Single Shield Reflector (S/S)
1001	Ø150mm x 1200mm Reflector (Matt Black)
1002	Ø150mm x 1200mm Deluxe Flue Shield (Matt Black)
1004	Back Extension for Deluxe Shield (Matt Black)
1013	Ø175mm x 1200mm Single Shield Reflector (S/S)
1019	Ø175mm x 1200mm Reflector (Matt Black)

## **APPENDICES**

**Information Note for Building Inspectors Re: Davin Industries Flue Systems**

	<b>DAVIN</b>	<b>INDUSTRIES LIMITED</b>	
	<i>Precision sheetmetal engineering through technology and craftsmanship</i>		
<small>Street address</small>	<small>Postal address</small>		
<b>11 EDISON PLACE</b>	<b>PO BOX 24 015</b>	<b>Telephone</b>	<b>+64 3 384 3099</b>
<b>BROMLEY</b>	<b>EASTGATE</b>	<b>Facsimile</b>	<b>+64 3 384 9666</b>
<b>CHRISTCHURCH 8062</b>	<b>CHRISTCHURCH 8642</b>	<b>e-mail</b>	<b>mail@davin.co.nz</b>
<b>NEW ZEALAND</b>	<b>NEW ZEALAND</b>		<b>ISO 9001</b>

**Attention: Building Inspectors****Re: Davin Industries Flue Systems.**

Please find enclosed Test Report data relating to the Davin Industries Flue systems as outlined below.

- Kit 2023 has been thermal tested in accordance and compliance with AS/NZ2918:2001 Appendix F (Thermal testing of flue systems and flue system clearances) by Applied Research Report no. 03/927 dated 18 November 2003.
- Kit 2074 complies with AS/NZ2918:2001 Appendix F as per report 04/969 dated 12 February 2004.
- Refer to AS/NZ2918:2001 for clarification.
- Note: As per AS/NZ2918:2001 section 4.1, note 2 "A tested flue system altered in any other way from the original specification is considered to be an 'untested' flue for the purposes of installation." Thus when such a situation arises that the flue system is deemed to be an 'untested' system then the installation should be completed as outlined in AS/NZ2918:2001. (refer section 4.5.1.2 for details)
- For installations where tested flue kits are not fitted, then clearances as outlined in AS/NZ2918:2001 shall apply.

If you have any further technical queries please call Peter Lambert on 384 5843.

## Thermal Testing Report for #2023 Double Shielded Flue Kit



(SUBJECT TO DEED OF COMPANY ARRANGEMENT)

P.O. Box 687, NELSON,  
NEW ZEALAND

PHONE (03) 547 7347

FAX (03) 547 2909

EMAIL: [info@appliedresearch.co.nz](mailto:info@appliedresearch.co.nz)

WEB: [www.appliedresearch.co.nz](http://www.appliedresearch.co.nz)

### Thermal Testing of the Davin Industries Double Shielded Flue Kit #2023 to AS/NZS2918:2001

Customer: Davin Industries Limited  
PO Box 24-015  
Bromley  
CHRISTCHURCH 8642

Report 03/927R2

November 2003



P.O. Box 687, NELSON,  
NEW ZEALAND

PHONE (03) 547 7347  
FAX (03) 547 2909  
EMAIL: [info@appliedresearch.co.nz](mailto:info@appliedresearch.co.nz)  
WEB: [www.appliedresearch.co.nz](http://www.appliedresearch.co.nz)

Report 03/927R2

November 18<sup>th</sup>, 2003

Page 1/5

Customer: Davin Industries Limited  
PO Box 24-015  
Bromley  
CHRISTCHURCH 8642

P808/1

Attention: Peter Lambert

**Thermal Testing of the Davin Industries Double Shielded Flue Kit #2023  
to AS/NZS2918:2001**

**1.0 Introduction**

A Double Shielded Flue Kit #2023 was supplied by Davin Industries and was tested for compliance to the requirements of AS/NZS2918:2001 Appendix F by Rob Kay in November 2003.

**1.1 Revision Details**

This report replaces report 03/927R1. The manufacturer's information has been updated to include the correct standard (AS/NZS2918:2001) and some minor re-formatting of the manufacturer's information has been completed.

**Accreditation**

Laboratory Registration Number 395

This laboratory is accredited by International Accreditation New Zealand (IANZ). The tests reported herein have been performed in accordance with the terms of our accreditation. This accreditation does not extend to any opinions or any interpretations of test results contained in this report.



IANZ has a Mutual Recognition Arrangement (MRA) with the National Association of Testing Authorities (NATA), Australia, such that both organizations recognize accreditations by IANZ and NATA as being equivalent. Users of test reports are recommended to accept test reports in the name of either accrediting body.

**2.0 Test Method**

Testing of the flue kit involved a "hot flue" test, where the base of the flue was heated at 760°C using a 15kW gas burner until temperatures on adjacent combustible surfaces stabilised. This was followed by a "flue fire" test, performed immediately after the hot flue test, where the base of the flue is raised to 1125°C with the gas burner increased to 28kW for 30 minutes. The structural integrity of the flue

Report 03/927R2

November 18<sup>th</sup>, 2003

Page 2/5

kit was then assessed after it had been subjected to two further (but shorter) cycles of hot flue and flue fire conditions.

### **3.0 Flue Installation Details**

A manufacturer-supplied diagram is shown in Appendix 1. Air enters the flue kit from the room below the ceiling or from the outside environment via a gap below the cowl, but not from the ceiling space. The kit comprises a stainless steel 150mm flue (the two lowest sections are satin black) surrounded by an inner casing of 200mm diameter and an outer casing of 250 mm diameter. The outer casing is installed flush with the ceiling surface at the lower end. The inner casing is installed on a spider whose lower edge is flush with the ceiling. The 200mm casing terminates above the roof, 600mm below the 250mm casing, which terminates at the same height as the 150mm flue.

### **4.0 Test Enclosure Details**

The test enclosure consists of two vertical side walls which enclose the flue system in the simulated first floor room. The two vertical side walls form a 90° corner at a distance 'X' from the outer shield. The dimension 'X' indicated in Figure F5 of AS/NZS2918 Appendix F was 25mm, i.e. the enclosure in the simulated roof cavity was 25mm away from the 250mm diameter outer casing.

### **5.0 Results**

Thermocouples were placed at points of contact between the outer casing and the wood of the test rig at the points of penetration as well as on the surface of the lower test rig module exposed to the hot flue. Thermocouples were fixed on the exposed ceiling surface adjacent to the ceiling plate.

Thermocouple locations were as specified in figure F5 of AS/NZS2918 Appendix F.

A summary of the results is as follows:

Thermocouple Location	Maximum Temperature Rise Above Ambient °C	
	Hot Flue Test	Flue Fire Test
1 60mm outside ceiling plate	25.4	42.7
2 10mm outside ceiling plate	20.0	32.7
3 Between ceiling frame and 250mm outer casing	13.5	24.3
4 Between enclosure/250mm outer casing, 50mm above floor	1.3	2.5
5 Between enclosure/ 250mm outer casing, 150mm above floor	0.9	2.0
6 Between enclosure/250mm outer casing, 250mm above floor	1.2	2.1
7 Between enclosure/250mm outer casing, 1000mm below roof penetration	1.6	2.5
8 Between enclosure/250mm outer casing, 50mm beneath roof module	5.4	6.3
9 Between roof module/250mm outer casing (roof penetration with 25mm combustibles clearance)	28.9	34.0

Report 03/927R2

November 18<sup>th</sup>, 2003

Page 3/5

The flue kit was disassembled at the completion of the test program and examined for structural integrity. We observed there was a hot spot in the flue in the area around the spider which supports the 200mm liner. No other structural damage in the components of the Double Shielded Flue Kit #2023 was observed after testing.

Ambient temperature ranged between 16.7°C and 18.8°C during the tests.

### **6.0 Compliance**

Section F9 of AS/NZS2918:2001 specifies that the temperature rise above ambient for combustible surfaces should not exceed 65°C during the hot flue test and 100°C during the flue fire test, and that the system maintains its structural integrity after completion of the test.

Based on the temperatures recorded above, the Double Shielded Flue Kit #2023 meets the requirements of AS/NZS2918:2001.

### **7.0 Installation**

It is Applied Research Services' opinion that the Davin Industries Double Shielded Flue Kit #2023 will be suitable for installation on appliances that also comply with the requirements of AS/NZS2918:2001 Appendix B or NZS7421:1990 Appendix B.

This report relates only to the product sample tested. Any modification to the product may invalidate the compliance results.

The original report was prepared by R.Kay and Approved by C.J.Mildon and released on 01 December 2003. The previous revision was prepared by R.Kay and approved by W.S.Webley and released on 10 May 2010.

#### **This revision:**

Prepared by: R. Kay

Approved by: W.S. Webley

Release Date:

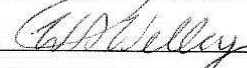
  
  
20-5-10

This report must not be reproduced except in full. Results are based on materials and information supplied by the client. Applied Research Services Ltd shall not be liable in respect of any loss or damage (including consequential loss or damage) resulting from use of reports prepared by them. Results issued in electronic form are subject to confirmation by issue of a final written report.

Report 03/927R2

November 18<sup>th</sup>, 2003

Page 4/5

**Appendix 1 Manufacturer's Installation Instructions and Flue Kit Diagrams**

### 150mm Free Standing Flue Kit Satin Black, 3.6 Metres (Kit Code 2023)

This flue kit must be installed by a suitably qualified tradesperson or solid fuel heater installer and complies with AS/NZS 2918:2001. This may require additional components to complete the installation.

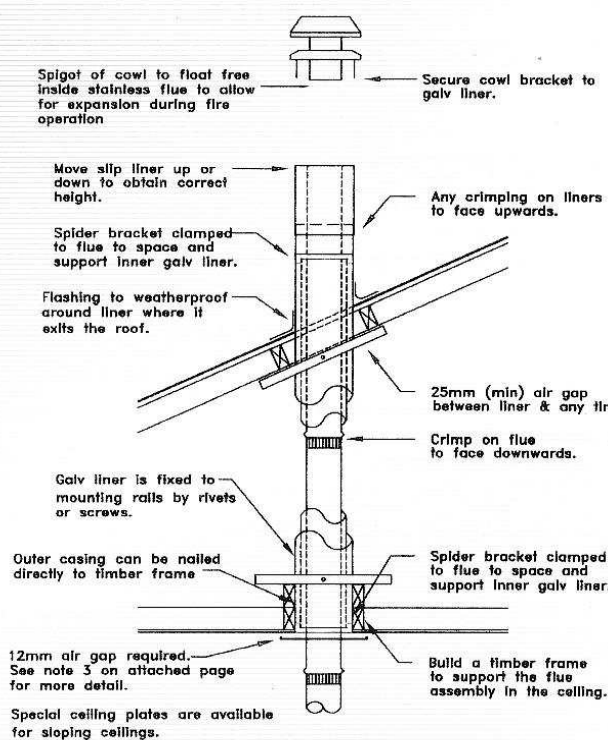
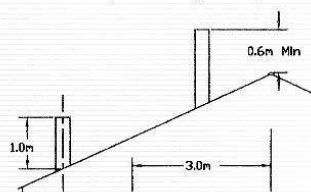
**Roof & Ceiling Installation****Minimum Height of Flue System Exit (excluding cowl)****Notes:**

- ① Refer to your heater manufacturers recommendations for flue heights.
- ② Depending on local circumstances, taller chimneys may be required for satisfactory performance. Check with your local building authority.

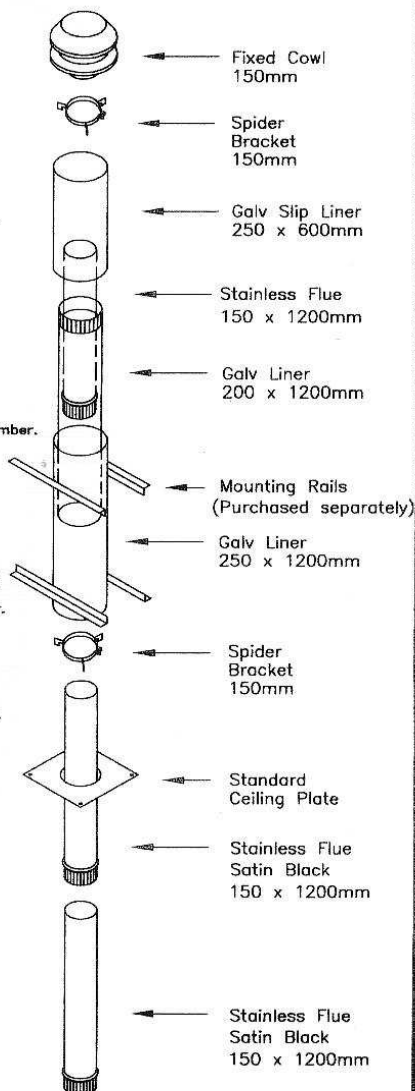
**Assembly List**

Report 03/927R2

November 18th, 2003

Page 5/5

NOTE 3:

POSITIONING LINERS AND CEILING PLATE

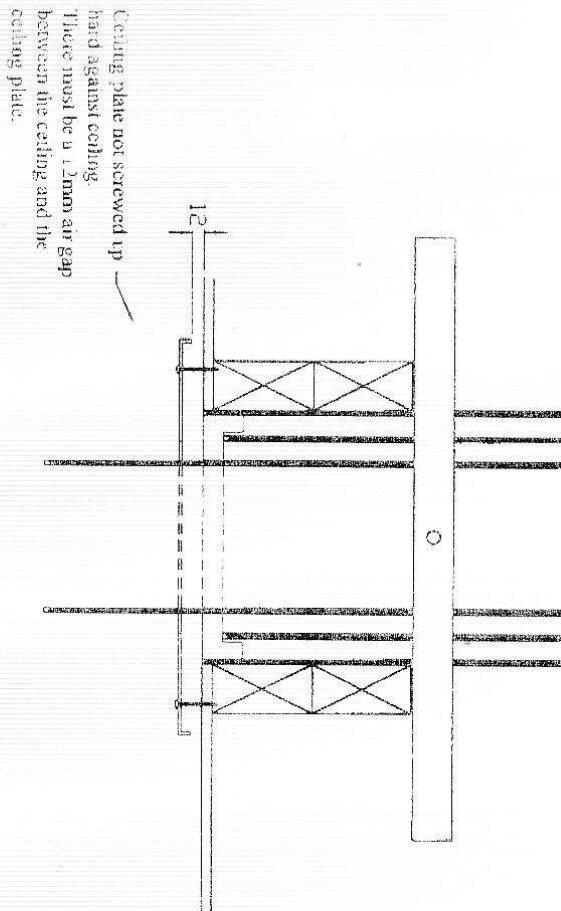

## Safety Opinion Report for #2074 Flue Kit

 **APPLIED  
RESEARCH**  
SERVICES LIMITED  
(SUBJECT TO DEED OF COMPANY ARRANGEMENT)

P.O. BOX 687, NELSON,  
NEW ZEALAND

PHONE (03) 547 7347  
FAX (03) 547 2909  
EMAIL: [info@appliedresearch.co.nz](mailto:info@appliedresearch.co.nz)  
WEB: [www.appliedresearch.co.nz](http://www.appliedresearch.co.nz)

### Variations in the Double Shielded Flue Kit #2023- Flue Kit #2074 Safety Opinion

**Customer:** Davin Industries Limited  
PO Box 24-015  
Bromley  
CHRISTCHURCH 8642

Report 04/969R1

February 2004



P.O. Box 687, NELSON,  
NEW ZEALAND

PHONE (03) 547 7347  
FAX (03) 547 2909  
EMAIL: info@appliedresearch.co.nz  
WEB: www.appliedresearch.co.nz

Report 04/969R1

February 12<sup>th</sup>, 2004

Page 1/2

Customer: Davin Industries Ltd  
P.O. Box 24-015  
Bromley  
CHRISTCHURCH 8642

P808/1

Attention: Andrew Smith

**Variations in the Double Shielded Flue Kit #2023 - Flue Kit #2074 Safety Opinion**

**1.0 Revision Details**

This report replaces report 04/969. The manufacturer's information has been updated to include the correct standard (AS/NZS2918:2001) and some minor re-formatting of the manufacturer's information has been completed. Re-formatting of this report was completed.

**2.0 Opinion**

The manufacturer has asked for our opinion on the likely safety performance of the Davin Industries Double Shielded Flue Kit #2074.

Flue Kit #2023 has been fully tested by us and reported in 03/927. Construction details for flue kit #2074 are identical to flue kit #2023 in the ceiling and roof penetration areas. There is a slight difference in the construction of the flue kit above the roof line - it is our opinion that the Davin Flue Kit #2074 will have similar operating characteristics to flue kit #2023, and report 03/927 will apply to both flue kits.

This report relates only to the product sample tested. Any modifications to the product may invalidate the compliance results.

The original report was prepared by C.J.Mildon and Approved by C.J.Mildon and released on 12 December 2004.

**This revision:**

Prepared by: R. Kay

Approved by: W.S. Webley

Release Date:

The block contains two handwritten signatures. The first signature, 'R. Kay', is written over a horizontal line. The second signature, 'W.S. Webley', is also written over a horizontal line. Below the second signature, the date '20-5-10' is handwritten.

This report must not be reproduced except in full. Results are based on materials and information supplied by the client. Applied Research Services Ltd shall not be liable in respect of any loss or damage (including consequential loss or damage) resulting from use of reports prepared by them. Results issued in electronic form are subject to confirmation by issue of a final written report.

Report 04/969R1

February 12<sup>th</sup>, 2004

Page 2/2

**Appendix 1 Information Supplied by the Manufacturer**

## 150mm Free Standing Flue Kit Satin Black, 4.2 Metres

(Kit Code 2074)

Manufactured by Davin Industries Limited.

This flue kit must be installed by a suitably qualified tradesperson or solid fuel heater installer and complies with AS/NZS 2918:2001. This kit may require additional components to complete the installation.

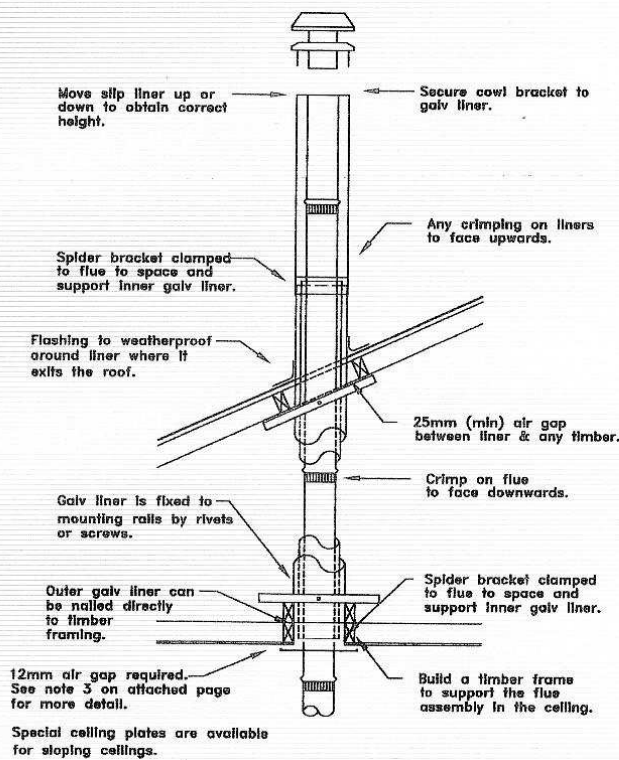
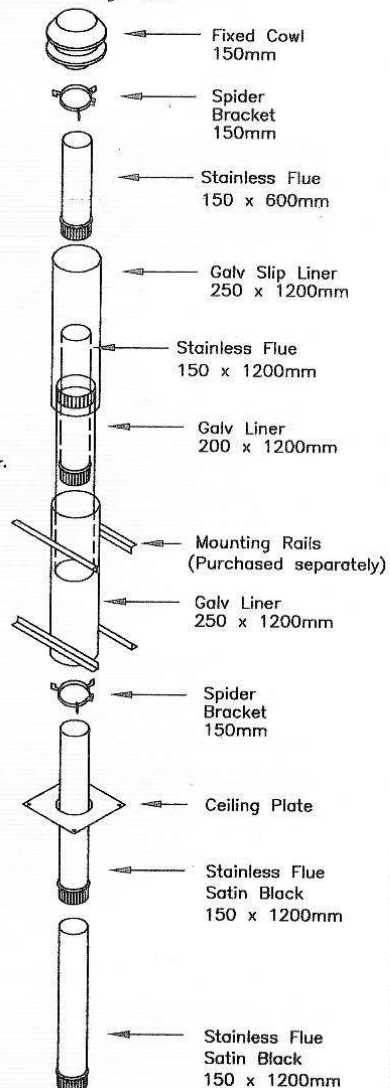
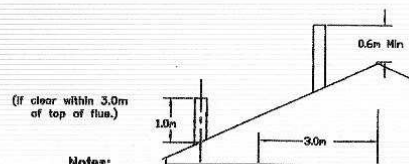
**Roof & Ceiling Installation****Assembly List****Minimum Height of Flue System Exit (excluding cowl)****Notes:**

- ① Refer to your heater manufacturers recommendations for flue heights.
- ② Depending on local circumstances, taller chimneys may be required for satisfactory performance. Check with your local building authority.